

Dear All,

As you may be aware I received a petition in June of this year from [a local resident], regarding safety concerns on Benham Hill Thatcham. In response to the concerns raised we have now designed a scheme that we believe will address these issues.

The concerns raised included, issues for pedestrians crossing the road and becoming trapped unprotected in the current hatched area, reports of motorcycles overtaking in the hatched area and concerns raised over conflict between pedestrians and cyclists.

This scheme offers a pedestrian refuge which helps pedestrians cross the road in two separate stages, offers a safe refuge in between stages and shortens the unprotected crossing distance.

The refuge and hard island to the west of the crossing will help to prevent motorcyclists overtake within the hatched area.

Improved cycle facilities through the junction will hopefully deter cyclists from using the footway and causing conflict for pedestrians and property owners exiting their properties.

I would appreciate any comments you have on the proposed scheme.

If it is agreed then we intend to carry out these works as part of the resurfacing works currently scheduled for the second quarter of 2019.

Kind regards  
Glyn Davis  
Principal Engineer  
Traffic Management & Road Safety



### KEY

- NEW FOOTWAY  
(230mm construction as per WBC Standard Detail)
- NEW CYCLEWAY  
(230mm construction as per WBC Standard Detail)
- EXISTING ROAD MARKINGS
- PROPOSED ROAD MARKINGS

### NOTES

1. DO NOT SCALE FROM THIS DRAWING.
2. ALL DIMENSIONS ARE SHOWN IN METRES UNLESS SHOWN OTHERWISE.
3. THIS DRAWING SHOWS A PROPOSED FEASIBILITY OPTION AND IS SUBJECT TO CHANGE.
4. WBC STANDARD DETAILS MUST BE ADHERED TO AT ALL TIMES UNLESS SPECIFIED BY THE OVERSEEING ORGANISATION.
5. PRIOR TO ANY EXCAVATIONS THE CONTRACTOR WILL ESTABLISH THE LOCATION OF EXISTING UTILITY SERVICES. THE CONTRACTOR SHOULD UNDERTAKE THEIR OWN UTILITY SEARCHES.
6. THE PURPOSE OF THIS PLAN IS TO IDENTIFY THE VARIOUS UTILITY APPARATUS LOCATIONS. WBC HAVE TRIED TO MAKE IT AS ACCURATE AS POSSIBLE BUT WE CANNOT GUARANTEE ITS ACCURACY, AS THE LOCATIONS HAVE BEEN DRAWN FROM PLANS SUPPLIED BY EACH INDIVIDUAL UTILITY COMPANY. THEREFORE, YOU MUST NOT RELY SOLELY ON THIS PLAN IF YOU ARE CARRYING OUT ANY EXCAVATION OR OTHER WORKS IN THE VICINITY OF THE UTILITY LOCATIONS SHOWN. THE ACTUAL POSITION OF ANY UNDERGROUND SERVICE MUST BE VERIFIED BY CABLE DETECTION EQUIPMENT, ETC., AND ESTABLISHED ON SITE BEFORE ANY EXCAVATION IS UNDERTAKEN. THERE MAY ALSO BE FURTHER SERVICES UNKNOWN TO WBC. WBC ACCEPT NO RESPONSIBILITY OR LIABILITY IN THE EVENT OF INACCURACY.

DRAFT

REV	REV DATE	DESCRIPTION	DR	AU



TRANSPORT AND COUNTRYSIDE  
COUNCIL OFFICES - MARKET STREET - NEWBURY - RG14 5LD

PROJECT TITLE  
**NCN422 CYCLE IMPROVEMENTS**

DRAWING TITLE  
**BENHAM HILL JW POUND LANE**

DATE	DRAWN BY	CHECKED BY	PAPER SIZE	SCALE
27/11/18	JBK	GD	A2	1:250

DRAWING NUMBER	REVISION
<b>81621-POUND-LANE</b>	

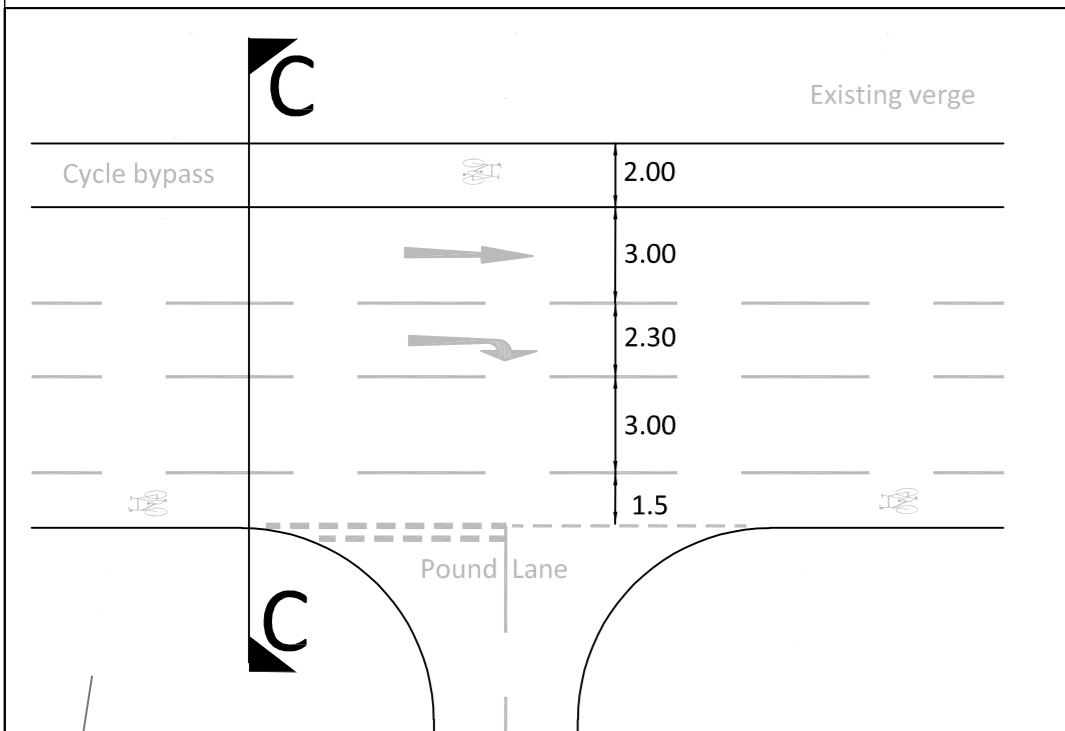
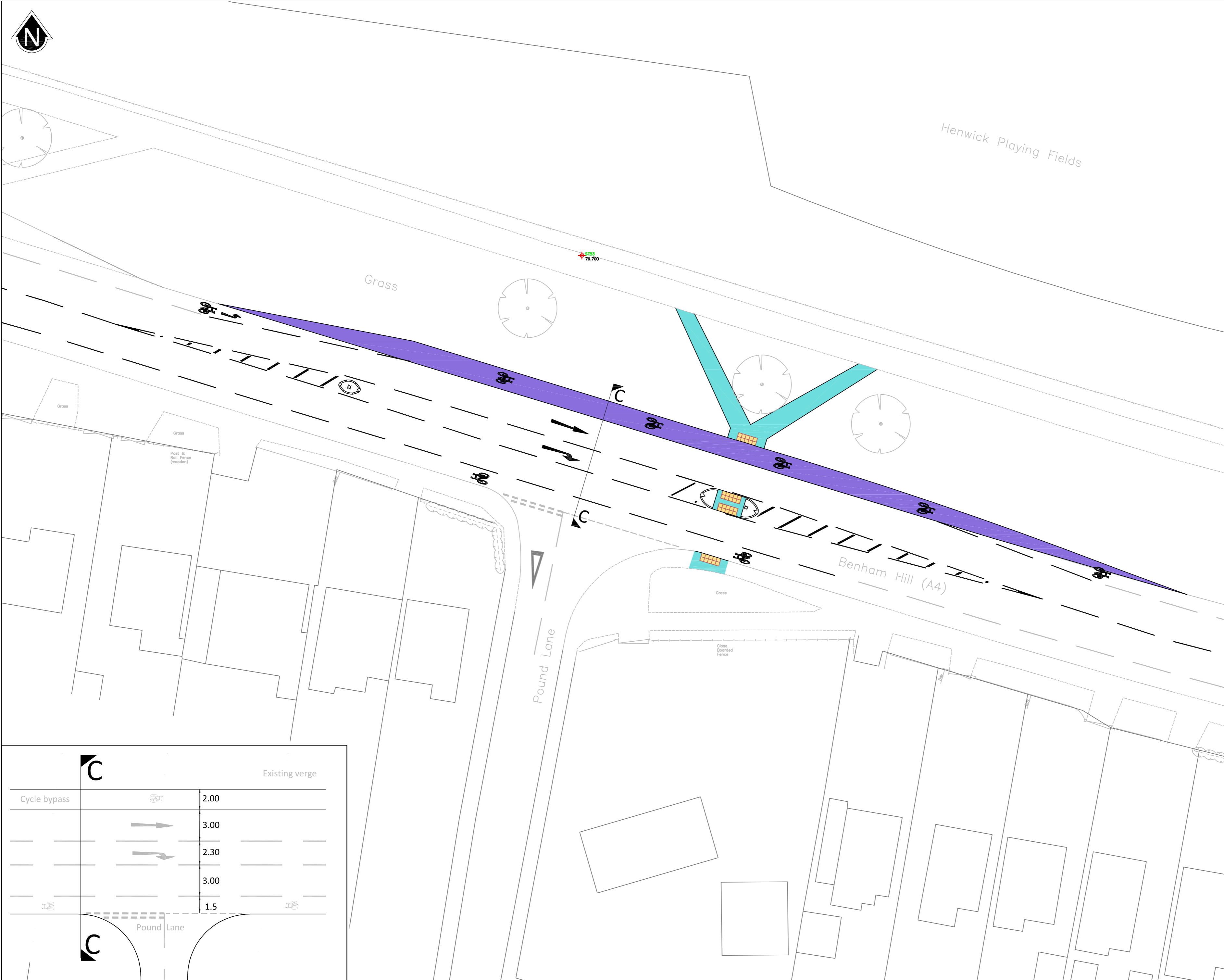

K:\Transport & Countryside\Projects\Highway Projects\A4 Newbury to Calton Cycle Improvements\CAD\Contract Drawings\Section 2 - Thatcham to Thatcham to Thatcham to Thatcham - Pound Lane.dwg